

# Ridgeville Township

**Section** 13  
**Date** 10/12/2005  
**Corner** NW  
 RR Spike w/Chiseled "+"

35.57' S.E. to duplex NE/side of power pole  
 34.63' S.W. to "+" south end of 21" RCP (P)  
 47.77' S.W. to duplex NW/side of telephone pole  
 36.59' N.W. to sawed "+" east wall of catch basin

NW	

**Section** 13  
**Date** 9/7/2018  
**Corner** N¼  
 RR Spike w/center punch

Mag Nails 2' north and 2' west  
 94.00' W.N.W. to sawed "+" south end of east concrete wall  
 30.36' N. to duplex E/side of power pole  
 63.26' N.W. to "+" NE/side of well casing

	N¼

**Section** 13  
**Date** 10/12/2005  
**Corner** NE  
 RR Spike

39.81' N.W. to "+" north wall of catch basin  
 62.71' N.E. to PK nail NW/side of power pole  
 83.92' E.N.E. to NW corner of porch foundation (No field check)  
 52.68' S.W. to PK nail E/side of power pole  
 131.40' S. to NW corner, Sec. 18, Freedom Twp.

	NE

# Ridgeville Township

**Section** 13  
**Date** 10/12/2005  
**Corner** W<sup>1</sup>/<sub>4</sub>

Small RR Spike

21.59' W. to nail/shiner N/side wood anchor post

70.88' N.N.E. to "+" SW corner conc. catch basin (P)

49.43' S.E. to nail/shiner SW/side power pole

W <sup>1</sup> / <sub>4</sub>	

**Section** 13  
**Date** 10/12/2005  
**Corner** E<sup>1</sup>/<sub>4</sub>

Iron pin 2' west of west edge of pavement Road 19.

Set new PK's 6' NE & SE

40.06' E.S.E. to duplex W/side of power pole

146.91' S.S.E. to duplex SW/side of power pole (No field check)

33.55' S.W. to "+" south end conc. headwall (P)

29.25' W.S.W. to "+" north end conc. headwall (P)

136.70' S. to W<sup>1</sup>/<sub>4</sub> Post, Sec. 18, Freedom Twp.(No field check)

140.51' N.N.E. to duplex W/side of power pole (No field check)

	E <sup>1</sup> / <sub>4</sub>

# Ridgeville Township

**Section** 14  
**Date** 10/12/2005  
**Corner** NW

RR Spike

36.34' N.W. to duplex SW/side of telephone pole

48.76' N.E. to "+" north end 54" RCP (P)

38.10' S.E. to duplex NE/side of power pole

41.06' S.E. to "+" south end 54" RCP (P)

NW	

**Section** 14  
**Date** 10/12/2005  
**Corner** N¼

RR Spike

29.18' N.E. to duplex NW/side buried cable marker

32.03' S.W. to duplex SE/side of power pole

	N¼

**Section** 14  
**Date** 10/12/2005  
**Corner** W¼

Small RR Spike

18.44' W. to nail/shiner N/side of power pole

29.89' E. to iron pin (P) (Buried)

42.08' E. to nail/shiner N/side of power pole

62.06' S. to PK nail W/side 12" hickory

W¼	

# Ridgeville Township

**Section** 15  
**Date** 10/12/2005  
**Corner** NW  
RR Spike

- 34.18' N.E. to duplex SE/side of brace pole
- 32.96' S.E. to spike SW/side of power pole
- 28.26' N.N.E. to "+" north end RCP (P)
- 52.63' S.S.E. to center of 15" dia. plastic grate

NW	

**Section** 15  
**Date** 10/12/2005  
**Corner** N¼  
RR Spike

- 43.70' S.W. to sawed "+" west end 12" helical pipe (P)
- 44.36' N.N.W. to spike W/side 30" oak (No field check)
- 36.45' N.E. to PK nail W/side telephone pole
- 33.49' S.E. to spike E/side power pole
- 29.00' S.E. to sawed "+" SE corner catch basin (P)

	N¼

**Section** 15  
**Date** 10/12/2005  
**Corner** W¼  
RR Spike

- 25.53' S.W. to duplex NW/side power pole
- 20.13' E. to sawed "+" W/side of bent 2" iron post

W¼	

# Ridgeville Township

**Section** 16  
**Date** 10/12/2005  
**Corner** NW  
See State Ties for SR 66

NW	

**Section** 16  
**Date** 10/12/2005  
**Corner** N¼  
RR Spike

21.37' S. to "+" top of 30" RCP (P)  
28.55' S.S.W. to spike N/side of power pole  
33.02' S.E. to sawed "+" north end 12" RCP (P)  
44.21' W.N.W. to sawed "+" SE corner conc. drive

	N¼

# Ridgeville Township

**Section** 17

**Date** 10/12/2005

**Corner** NW

Found Monument Box. See Fulton Co. Engineer

NW	

**Section** 17

**Date** 5/23/2014

**Corner** N¼

Small RR Spike

118.45' W.N.W. to duplex S/side of power pole

89.79' E.N.E. to duplex S/side of power pole

11.66' S. to iron pin 3' south of edge of pavement

	N¼

**Section** 17

**Date** 10/12/2005

**Corner** W¼

RR Spike

60.00' S.E. to PK nail W/side of power pole

32.10' N.W. to sawed "+" SW corner of catch basin (P)

25.91' N.E. to PK nail in driveway approach

W¼	

# Ridgeville Township

**Section** 18  
**Date** 10/12/2005  
**Corner** NW

Nail/Shiner in Bridge Deck

25.58' N.W. to "+" northwest bridge wing (P)

25.80' N.E. to "+" northeast bridge wing (P)

44.77' S.E. to "+" southeast bridge wing (P)

44.88' S.W. to "+" southwest bridge wing (P)

NW	

**Section** 18  
**Date** 10/12/2005  
**Corner** N¼

Small RR Spike

24.25' N.W. to "+" southeast corner catch basin (P)

24.59' N.W. to nail/shiner E/side power pole

25.80' S.W. to "+" southeast corner of new catch basin (P)

	N¼

**Section** 18  
**Date** 10/12/2005  
**Corner** W¼

RR Spike

20.96' W. to duplex S/side power pole (P)

24.88' E.S.E. to duplex N/side power pole (P)

91.70' S.S.W. to nail/shiner E/side power pole

19.43' N.E. to "+" in north end helical pipe (P)

W¼	

# Ridgeville Township

**Section** 19

**Date** 10/12/2005

**Corner** NW

RR Spike. Set new PK's 6' N & W

89.17' N.N.W. to "+" west end RCP (P)

84.50' N.N.E. to "+" east end RCP (P)

72.57' S.S.E. to PK nail W/side power pole

NW	

**Section** 19

**Date** 10/12/2005

**Corner** N¼

Small RR Spike

29.26' N.E. to duplex southeast corner wood post

40.43' W.S.W. to PK nail NE/side power pole

	N¼

**Section** 19

**Date** 10/12/2005

**Corner** W¼

Small RR Spike

26.20' N.E. to duplex W/side RR tie brace post

22.04' N.E. to duplex W/side RR tie gate post

20.85' W. to duplex S/side wood anchor post

43.03' N.W. to duplex E /side wood anchor post

44.30' E. to duplex S/side wood anchor post

W¼	



# Ridgeville Township

**Section** 19

**Date** 10/12/2005

**Corner** S<sup>1</sup>/<sub>4</sub> SW

Iron pins W.N.W. & W.S.W. bent.

Did not find iron pin recorded as being over stone

Catch Basins have been replaced.

S <sup>1</sup> / <sub>4</sub> SW	

# Ridgeville Township

**Section** 20  
**Date** 10/12/2005  
**Corner** NW

RR Spike

66.04' W.S.W. to sawed "+" west end RCP (P)

65.44' N.N.W. to sawed "+" southwest corner catch basin (P)

64.85' N.N.E. to sawed "+" southeast corner catch basin (P)

64.71' E.S.E. to sawed "+" east end RCP (P)

NW	

**Section** 20  
**Date** 10/12/2005  
**Corner** N¼

Small RR Spike

67.23' S.E. to northeast corner block porch foundation

63.22' S.S.E. to northwest corner block house foundation

17.24' S.S.W. to "+" east end helical pipe (P)

63.62' E.S.E. to PK nail W/side power pole

	N¼

**Section** 20  
**Date** 10/12/2005  
**Corner** W¼

RR Spike

70.66' S.S.E. to "+" in bridge wing

99.55' S.S.W. to "+" in bridge wing

W¼	

# Ridgeville Township

**Section** 21  
**Date** 10/13/2005  
**Corner** NW  
Nail/Shiner on Surface

NW	

**Section** 21  
**Date** 10/13/2005  
**Corner** N¼  
Small RR Spike

43.70' N.W. to duplex SW/side power pole  
92.59' W.S.W. to nail/shiner N/side power pole  
69.64' W.N.W. to "+" east end helical pipe

	N¼

**Section** 21  
**Date** 10/13/2005  
**Corner** W¼  
Nail/Shiner on Surface

W¼	

# Ridgeville Township

**Section** 22  
**Date** 10/13/2005  
**Corner** NW

Small RR Spike

31.57' N.W. to southeast corner metal anchor post

28.41' N.E. to "+" SW/side round anchor post

100.45' E.S.E. to duplex N/side power pole

109.14' W.S.W. to duplex N/side power pole

NW	

**Section** 22  
**Date** 10/13/2005  
**Corner** N¼

Small RR Spike

120.31' E.S.E. to duplex N/side power pole

82.29' W.S.W. to duplex N/side power pole

18.96' N.N.W. to iron pin

	N¼

**Section** 22  
**Date** 10/13/2005  
**Corner** W¼

RR Spike - 6.5' east of west edge 16' pavement

17.12' W. to near face iron anchor post

33.99' N.E. to rivet north end 12" CMP (P)

21.17' E.N.E. to PK nail south end 12" CMP (P)

W¼	

# Ridgeville Township

**Section** 22

**Date** 10/13/2005

**Corner** W $\frac{1}{4}$  SW

Small RR Spike

56.53' N.N.E. to "+" north end 48" RCP (P)

93.93' N.E. to southwest corner house foundation

29.75' S.E. to "+" southeast corner catch basin (P)

38.35' S.E. to duplex SW/side power pole

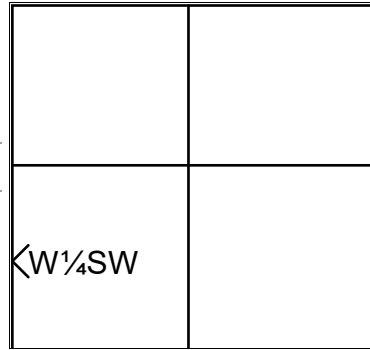

**Section** 22

**Date** 10/13/2005

**Corner** W $\frac{1}{4}$  SE

Small RR Spike

23.78' S. to duplex E/side power pole

19.16' N.W. to iron pin 6' north of north edge 18' pavement

19.00' N.E. to iron pin 6' north of north edge 18' pavement

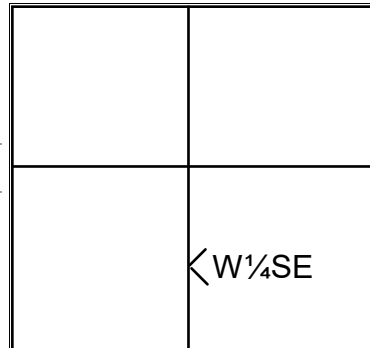

# Ridgeville Township

**Section** 23

**Date** 10/13/2005

**Corner** NW

Small RR Spike

26.15' N.W. to duplex NE/side power pole

29.40' N.E. to 5/8" iron pin (P)

28.99' N.W. to sawed "+" in southerly corner catch basin (P)

NW	

**Section** 23

**Date** 10/13/2005

**Corner** N¼

Iron Pin

31.75' N.W. to ¾" iron pin

25.78' S. to near face round iron post S/side of ditch

32.63' N.W. to mag nail W/side 12" tree

48.11' N.E. to mag nail SE/side 8" tree

	N¼

**Section** 23

**Date** 10/13/2005

**Corner** W¼

RR Spike

106.48' N.N.W. to nail/shiner NE/side power pole

69.97' N.E. to nail/shiner south root of pine tree

20.32' W. to duplex S/side wood post

W¼	

# Ridgeville Township

**Section** 24

**Date** 10/13/2005

**Corner** NW

2" Disk with "+" in Center

33.56' N.W. to nail/shiner E/side brace pole

36.28' N.E. to nail/shiner W/side power pole

33.51' S.W. to duplex SE/side telephone pole

NW	

**Section** 24

**Date** 10/13/2005

**Corner** N¼

Small RR Spike

36.89' N.N.E. to duplex S/side 24" walnut

16.71' S.W. to "+" south end 66" RCP (P)

66.09' W.N.W. to duplex S/side power pole

	N¼

**Section** 24

**Date** 10/13/2005

**Corner** NE

RR Spike - 1.5' West of West Edge Pavement, Rd. 19

75.51' W.N.W. to duplex S/side power pole

31.66' N.W. to new sawed "+" north end RCP (P)

47.15' N.E. to duplex NW/side power pole

41.53' E.S.E. to duplex N/side buried cable marker

147.84' S. to NW corner, Sec. 19, Freedom Twp. (No field check)

98.95' S.S.E. to nail/shiner SW/side power pole

32.13' S.W. to "+" south end CIP (P)

43.83' S.W. to duplex N/side buried cable marker (loose)

	NE

# Ridgeville Township

**Section** 24

**Date** 10/13/2005

**Corner** W<sup>1</sup>/<sub>4</sub>

RR Spike - 2' East of West Edge 16' Pavement

62.73' N.W. to PK nail SE/side telephone pole

73.70' N.N.E. to mag nail W/side power pole

116.61' S.S.W. to duplex E/side telephone pole (No field check)

32.11' S.E. to mag nail north end corr. plastic drive pipe

W <sup>1</sup> / <sub>4</sub>	

**Section** 24

**Date** 10/13/2005

**Corner** E<sup>1</sup>/<sub>4</sub>

Small RR Spike - 10' East of West Edge of Pavement.

PK's 3' NE & SE

79.80' E.N.E. to southwest corner metal building foundation

39.29' E. to nail/shiner N/side power pole

2.57' N. to W<sup>1</sup>/<sub>4</sub> Post, Sec. 19, Freedom Twp.

102.15' N.E. to northwest corner metal building foundation

	E <sup>1</sup> / <sub>4</sub>



# Ridgeville Township

**Section** 25  
**Date** 10/19/2005  
**Corner** NW  
 RR Spike

- 42.70' W.N.W. to PK nail west end 48" CMP (P)
- 34.05' N.W. to duplex S/side telephone pole
- 40.14' N.N.W. to PK nail north end 48" CMP (P)
- 30.99' N.E. to duplex NW/side power pole
- 48.11' E.N.E. to PK nail east end 48" CMP (P)
- 33.00' S.W. to duplex SE/side telephone pole

NW	

**Section** 25  
**Date** 10/19/2005  
**Corner** N¼  
 PK Nails 3' S.E. & S.W.

- Placed 5/8" iron pin 0.5' N of N edge of pav't from found PK's.
- Top of iron pin is 2" below edge of pavement
- 35.80' N.E. to 5/8" iron pin on north ditch bank
- 33.90' N.W. to 5/8" iron pin on north ditch bank
- 47.88' S. to duplex E/side power pole
- 21.27' N.N.E. to duplex E/side power pole

	N¼

**Section** 25  
**Date** 10/13/2005  
**Corner** NE  
 Small RR Spike

- 34.85' N.E. to duplex NW/side power pole
- 35.58' S.E. to duplex NE/side power pole
- 45.60' S.W. to mag nail 13"± from end corrugated plastic pipe (P)
- 37.21' N.W. to mag nail 13"± from end corrugated plastic pipe (P)
- 30.15' S.E. to duplex SE/side power pole (No field check)
- 8.10' N. to NW corner, Sec. 30, Freedom Twp. (No field check)

	NE

# Ridgeville Township

**Section** 25

**Date** 10/13/2005

**Corner** E<sup>1</sup>/<sub>4</sub>

RR Spike - 3" Below Surface

19.04' E.N.E. to near face pipeline marker (No field check)

42.77' N.N.E. to duplex S/side power pole

54.50' N.E. to duplex SE/side power pole

31.54' N.W. to sawed "+" southeast corner catch basin (P)

	E <sup>1</sup> / <sub>4</sub>

---

---

---

---

---

---

---

---

# Ridgeville Township

**Section** 26  
**Date** 10/13/2005  
**Corner** NW

Small RR Spike

22.05' N.W. to "+" southeast corner conc. catch basin (P)

45.98' S.E. to PK nail east end 12" CMP (P)

40.08' S.S.W. to PK nail south end 36" CMP (P)

34.82' S.W. to duplex NW/side power pole

39.90' N.W. to duplex SW/side cable marker post

NW	

**Section** 26  
**Date** 10/13/2005  
**Corner** N¼

Small RR Spike

28.62' N.N.W. to nail/shiner E/side power pole

51.01' S.E. to nail/shiner SW/side telephone pole

39.58' S.W. to duplex SE/side power pole

48.87' E.S.E. to duplex NE/side telephone pole

	N¼

**Section** 26  
**Date** 10/13/2005  
**Corner** W¼

Small RR Spike

15.53' S.W. to 5/8" iron pin

16.00' N.W. to 5/8" iron pin

18.15' E.N.E. to 5/8" iron pin

W¼	

# Ridgeville Township

**Section** 26

**Date** 10/13/2005

**Corner** CENTER

RR Spike 2" below Surface

23.13' E.N.E. to duplex NW/side telephone pole

22.08' E. to iron pin (P) (No field check)

30.43' S.W. to "+" south end conc. headwall

19.98' W.S.W. to "+" north end conc. headwall

21.10' W. to duplex N/side power pole

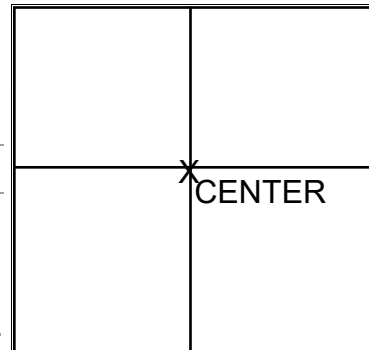

# Ridgeville Township

**Section** 27  
**Date** 2/23/2016  
**Corner** NW

Iron Pin w/Cap. Verified stone location - 2 RR spikes near corner, 3' apart.  
 Ties of 1982 & 2005 indicated north spike to be corner. GPS coordinates indicated south spike.  
 Found stone 12" below road under north spike (5"x9"x9"). Replaced spike with IP w/cap over high pt. of stone. Set mag nails 3' north & west of iron pin.  
 Dug hole 18" deep under south spike, found nothing. Replaced spike w/5/8" IP.  
 Set mag nails 6' west and south. Origin of south RR spike unknown.  
 14.79' W to 5/8" iron pin at west edge of pavement  
 32.96' NNE to "X" in south end of headwall  
 40.70' NNE to "X" in north end of headwall. 39.62' NE to "X" in metal pipe  
 27.72' E to 5/8" iron pin on east ditch bank.

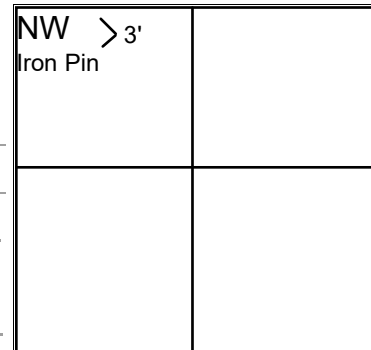

**Section** 27  
**Date** 10/17/2005  
**Corner** W 1/4

RR Spike  
 72.81' W. to nail/shiner N/side AT&T marker post  
 41.92' W.N.W. to "+" N/side telephone manhole  
 28.77' N.W. to nail/shiner NE/side AT&T marker post  
 104.78' N.N.W. to duplex E/side power pole  
 42.32' N.E. to nail/shiner NW/side AT&T marker post

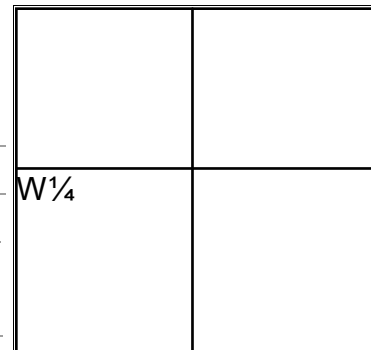

**Section** 27  
**Date** 10/17/2005  
**Corner** OTHER

RR Spike 2" Below Surface  
 39.28' N.W. to duplex SW/side underground cable marker  
 43.50' N.N.E. to "+" southwest corner catch basin (P)  
 33.03' S.E. to duplex NE/side power pole  
 28.17' S.E. to "+" northeast corner catch basin (P) (Buried)

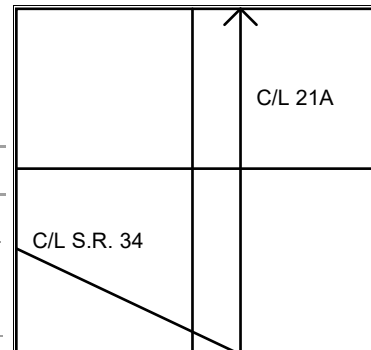

# Ridgeville Township

**Section** 27

**Date** 10/17/2005

**Corner** OTHER

Small RR Spike

50.78' N.E. to duplex W/side 48" oak

18.04' S.E. to PK nail east end CMP (P)

25.12' S.W. to PK nail west end CMP (P)

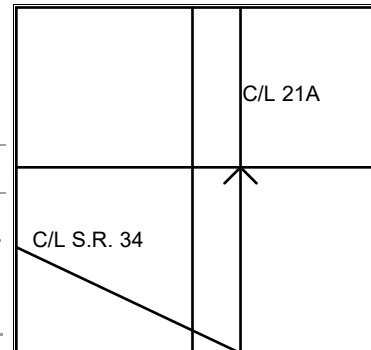

# Ridgeville Township

**Section** 28  
**Date** 10/17/2005  
**Corner** NW  
PK Nail/Shiner

- 35.16' E.S.E. to sawed "+" NW corner conc. slab (P)
- 54.71' W.N.W. to duplex S/side power pole
- 29.20' W.N.W. to "+" N/side manhole rim
- 36.19' S.E. to duplex/shiner SW/side power pole
- 35.76' N.E. to nail/shiner SW/side power pole

NW	

**Section** 28  
**Date** 10/17/2005  
**Corner** W<sup>1</sup>/<sub>4</sub>  
Picked up metal with detector under pavement surface, 1' west of center line.

- 
- 
- 
- 
- 
- 
- 
- 
- 
- 

W <sup>1</sup> / <sub>4</sub>	

# Ridgeville Township

**Section** 29  
**Date** 10/17/2005  
**Corner** NW  
Small RR Spike

- 24.95' S.E. to sawed "+" northwest corner catch basin (P)
- 49.83' S.W. to sawed "+" west end RCP (P)
- 42.95' N.W. to PK nail SE/side power pole
- 50.50' N.N.W. to duplex SW/side power pole

NW	

**Section** 29  
**Date** 10/17/2005  
**Corner** N¼  
Small RR Spike

- 26.96' S.W. to 5/8" iron pin on south ditch bank (P)
- 28.43' S.E. to 5/8" iron pin on south ditch bank (P)
- 111.26' W.N.W. to PK nail/shiner E/side power pole
- 20.02' N. to iron pin (P)

	N¼

**Section** 29  
**Date** 10/17/2005  
**Corner** W¼  
RR Spike

- 25.55' N.W. to 5/8" iron pin 5' west of west edge of pavement
- 35.96' N.E. to PK 1' south of north end 12" corr. plastic pipe (P)
- 22.61' E. to PK 1' north of south end 12" corr. plastic pipe (P)

W¼	



# Ridgeville Township

**Section** 30

**Date** 10/17/2005

**Corner** NW

RR Spike - 3" below Surface

22.20' S.W. to "+" N/side rim of VCP catch basin (P)

64.68' W.S.W. to duplex SE/side power pole

28.39' N.W. to duplex NE/side power pole

NW	

**Section** 30

**Date** 10/17/2005

**Corner** W<sup>1</sup>/<sub>4</sub>

RR Spike

23.60' N.E. to "+" in north end conc. retaining wall (P)

16.67' E.S.E. to "+" in south end conc. retaining wall (P)

32.68' S.W. to PK nail in northeast corner wood anchor post

W <sup>1</sup> / <sub>4</sub>	

# Ridgeville Township

**Section** 31

**Date** 10/17/2005

**Corner** NW

Nail/Shiner

38.85' N.E. to "+" north end 36" CMP (P)

55.65' S.E. to "+" south end 36" CMP (P)

29.95' S. to Williams Co. Corner (No field check)

NW	

**Section** 31

**Date** 10/17/2005

**Corner** N¼

Nail/Shiner

	N¼

**Section** 31

**Date** 10/17/2005

**Corner** W¼

Small RR Spike

23.11' S.W. to sawed "+" south end of headwall

20.83' N.W. to sawed "+" north end of headwall

52.74' N.E. to duplex W/side power pole

22.91' E.N.E. to sawed "+" northeast corner conc. box (P)

23.60' E.S.E. to sawed "+" southeast corner conc. box (P)

W¼	

# Ridgeville Township

**Section** 31  
**Date** 10/17/2005  
**Corner** SW

Iron Pin

54.38' N.W. to sawed "+" top wingwall (P)

82.67' W.S.W. to "Date" nail ("62") N/side telephone pole

46.76' N.E. to duplex W/side power pole

20.92' S.E. to "+" north end 12" hub rail

36.92' S.S.E. to "+" south end 12" hub rail

46.46' S.S.E. to nail/shiner N/side power pole

84.54' N.E. to center of GPS Monument "Ridge 31" (P)

SW	

**Section** 31  
**Date** 10/17/2005  
**Corner** S<sup>1</sup>/<sub>4</sub>

Iron Pin

74.25' N.W. to bottom corner, southeast leg of Toledo Ed. tower

31.05' N. to duplex W/side power pole

49.83' N.E. to duplex E/side power pole (No field check)

9.88' S. to duplex N/side brace pole

41.98' W.S.W. to duplex N/side brace pole

	S <sup>1</sup> / <sub>4</sub>

# Ridgeville Township

**Section** 32

**Date** 10/17/2005

**Corner** NW

PK Nail/Shiner

47.45' N.E. to "+" north end 21" RCP (P)

48.83' S.E. to USGS BM "47EAB" in SW corner catch basin

50.10' S.E. to nail/shiner NW/side power pole

92.00' S.W. to nail/shiner SE/side telephone pole

NW	

**Section** 32

**Date** 10/17/2005

**Corner** N¼

Did not locate

4/13/82 - PK Nail (1982 Ties)

48.70' S.E. to near edge witness post (No field check)

45.40' S.S.E. to duplex/shiner E/side telephone pole (No check)

43.33' S.S.W. to nail/shiner N/side wood anchor post (No check)

43.06' S. to duplex/shiner E/side wood anchor post (No check)

58.15' S.W. to iron pin N/side of witness post (No field check)

	N¼

**Section** 32

**Date** 10/17/2005

**Corner** W¼

Small RR Spike

38.79' N.W. to PK nail 1' south of north end 12" plastic pipe (P)

26.33' W. to PK nail 1' north of south end 12" plastic pipe (P)

W¼	

# Ridgeville Township

**Section** 32

**Date** 11/16/2018

**Corner** SW

RR Spike - Replaced due to construction (Used GPS)

50.45' N.E. to mag nail SE/side power pole

57.15' E.S.E. to sawed "+" in conc. pipe (P)

56.70' S.W. to sawed "+" west end conc. elliptical pipe (P)

62.62' S.E. to sawed "+" east end conc. elliptical pipe (P)

Monument box 6"± beneath top of asphalt.

SW

**Section** 32

**Date** 10/17/2005

**Corner** S<sup>1</sup>/<sub>4</sub>

Small RR Spike

96.63' N.N.W. to duplex SW/side power pole

68.03' E.S.E. to iron pin in conc. monument

119.30' E.N.E. to duplex S/side power pole

S<sup>1</sup>/<sub>4</sub>

# Ridgeville Township

**Section** 33  
**Date** 12/4/2015  
**Corner** NW

RR Spike over Nail & Shiner

67.5' N.E. to chiseled "X" in east end of RCP

55.52' N.W. to chiseled "X" in west end of RCP

84.62' S.W. to chiseled "X" in west end of RCP

NW	

**Section** 33  
**Date** 10/17/2005  
**Corner** N¼

RR Spike

37.46' S.S.E. to PK nail east end 15" CMP (P)

37.18' S.S.W. to PK nail west end 15" CMP (P) (No field check)

52.24' S.S.W. to duplex E/side telephone pole

52.06' S.S.W. to duplex E/side wood anchor post

51.72' S.S.E. to nail/shiner NW/side wood anchor post

55.52' S.E. to nail/shiner N/side wood fence post

	N¼

**Section** 33  
**Date** 8/24/2018  
**Corner** W¼

Railroad Spike

Found deteriorated nail/shiner. Dug down to pin located in 1982

by engineer's office. Pin placed in position of wood hub & stake.

Placed railroad spike over pin.

77.60' S.W. to nail/shiner E/side power pole (Leaning east)

25.78' N.W. to drilled hole in chiseled "x" N/end west bridge rail.

20.37' W.N.W. to drilled hole in chiseled "x" S/end west bridge rail

16.34' E.N.E. to drilled hole in chiseled "x" S/end east bridge rail

20.51' N.E. to drilled hole in chiseled "x" N/end east bridge rail

W¼	

# Ridgeville Township

**Section** 33  
**Date** 10/17/2005  
**Corner** SW

Small RR Spike

52.31' N.W. to duplex SW/side power pole

75.84' N.N.W. to duplex E/side power pole

53.35' N.E. to duplex SE/side power pole

84.80' S.E. to duplex NE/side power pole

39.17' S.W. to duplex W/side telephone pole

31.03' S.W. to sawed "+" west end conc. pipe (P)

SW	

**Section** 33  
**Date** 10/19/2005  
**Corner** S<sup>1</sup>/<sub>4</sub>

RR Spike - 2" Below Surface

20.30' N.N.W. to new duplex W/side telephone pole

21.04' N.N.W. to sawed "+" S/side conc. anchor post

58.72' E. to N<sup>1</sup>/<sub>4</sub> Post, Sec. 4, Adams Twp., Defiance Co. (No field check)

75.91' W.S.W. to duplex N/side new power pole

	S <sup>1</sup> / <sub>4</sub>

# Ridgeville Township

**Section** 34  
**Date** 10/18/2005  
**Corner** NW  
PK Nail

49.59' N.W. to "+" west end 15" RCP (P)  
50.30' N.E. to "+" east end 15" RCP (P)  
48.85' S.E. to "+" east end 15" RCP (P)  
49.86' S.W. to west end 15" RCP (P)

NW	

**Section** 34  
**Date** 10/18/2005  
**Corner** N¼  
Nail/Shiner

44.72' S.E. to nail/shiner E/side of east anchor post  
43.02' S. to nail/shiner W/side of west anchor post  
44.92' S. to nail/shiner W/side telephone pole

	N¼

**Section** 34  
**Date** 10/18/2005  
**Corner** W¼  
RR Spike on Surface (P)

19.16' W. to duplex N/side power pole  
20.25' W. to iron pin (bent)  
102.62' N.E. to duplex W/side cable marker  
20.05' E. to iron pipe  
23.48' N.W. to "+" in top of CIP (Pipe 4+" below ground line)  
15.98' W. to "+" in top of CIP (P)

W¼	



# Ridgeville Township

**Section** 34

**Date** 10/18/2005

**Corner** SW

Bent Iron Pin 2" below Surface. Mag nails 6' N & 6' W of True Pt

Set mag nail on surface. Point is 6½' north of south edge pav't.

35.54' N.W. to duplex SW/side telephone pole

32.80' N.W. to new "+" north end 12" conc. pipe (P)

59.12' N.N.E. to duplex W/side telephone pole

32.70' S.E. to duplex W/side power pole

25.63' S.W. to new "+" south end 12" conc. pipe

69.00' E.S.E. to new "+" W/side conc. anchor post (leaning east)

54.81' N.W. to duplex E/side power pole

SW

**Section** 34

**Date** 10/18/2005

**Corner** S¼

Mag Nail

36.51' W.N.W. to nail/shiner SW/side telephone pole

16.81' N.E. to PK nail north end 18" CMP (P)

20.77' S.E. to "+" in south rivet 18" CMP (P)

48.49' W.S.W. to "+" northeast corner conc. headwall (P)

S¼

# Ridgeville Township

**Section** 35  
**Date** 10/18/2005  
**Corner** NW

Small RR Spike

44.03' N.W. to "+" north bolt of gas valve

109.54' N.N.E. to duplex W/side telephone pole

91.79' S.S.E. to PK nail N/side power pole

34.95' S.W. to 5/8" iron pin on west ditch bank

NW	

**Section** 35  
**Date** 10/18/2005  
**Corner** N¼

Iron Rod 2" Below Surface

21.24' E. to duplex N/side telephone pole

30.53' S.E. to hinge nail NE/side power pole

72.78' E.S.E. to northwest corner brick house (No field check)

92.61' S.S.E. to southwest corner porch stoop (No field check)

36.33' N.W. to duplex NE/side power pole

19.50' S.E. to top of "L" (Elmira) W/side fire hydrant

	N¼

**Section** 35  
**Date** 10/18/2005  
**Corner** SW

Small RR Spike

122.32' W.N.W. to southeast corner conc. barn foundation

61.14' N.W. to duplex S/side telephone pole

17.16' E. to northeast corner Sec. 3, Adams Twp., Defiance Co.

42.12' S.W. to duplex SE/side power pole

31.58' S.W. to sawed "+" east end RCP (P)

33.36' S.W. to duplex SW/side meter pole

SW	

# Ridgeville Township

**Section** 36  
**Date** 10/19/2005  
**Corner** NW

Small RR Spike

27.25' N.N.E. to 60d spike S/side power pole

21.40' S.S.E. to duplex W/side power pole

64.02' S.W. to northeast corner conc. building foundation

55.58' S.W. to sawed "+" top conc. curb

NW	

**Section** 36  
**Date** 10/19/2005  
**Corner** N¼

Small RR Spike

18.87' N.W. to PK nail north end 6" CMP (P)

19.29' N. to "+" south end CIP (P)

143.23' E.S.E. to duplex N/side power pole

20.04' S. to iron pin (P) (Bent)

128.07' W.S.W. to duplex SE/side power pole

	N¼

**Section** 36  
**Date** 10/19/2005  
**Corner** NE

RR Spike - 2" Below Surface

87.07' N.W. to duplex S/side cable marker post

106.81' N.E. to duplex E/side power pole

70.17' S.E. to duplex W/side power pole

33.32' S.W. to "+" northeast corner catch basin (P)

31.62' S.W. to duplex E/side power pole

63.45' N.E. to duplex W/side power pole

	NE

# Ridgeville Township

**Section** 36  
**Date** 10/18/2005  
**Corner** W<sup>1</sup>/<sub>4</sub>

Small RR Spike

20.03' E. to iron pin

26.71' S.W. to 5/8" iron pin on west ditch bank (P)

26.18' N.W. to 5/9" iron pin on west ditch bank (P)

W <sup>1</sup> / <sub>4</sub>	

**Section** 36  
**Date** 10/19/2005  
**Corner** E<sup>1</sup>/<sub>4</sub>

RR Spike - 2" Below Surface

22.81' N.W. to PK nail south end 12" CMP (P)

39.14' N.N.W. to PK nail north end 12" CMP (P)

	E <sup>1</sup> / <sub>4</sub>

**Section** 36  
**Date** 10/18/2005  
**Corner** SW

RR Spike

11.99' W. to NW corner, Sec. 1, Adams Twp., Defiance Co.

73.70' S.S.W. to duplex SE/side power pole

52.92' S.W. to duplex SE/side power pole

74.15' S.S.E. to duplex SW/side cable marker post

60.10' W.S.W. to sawed "+" south end RCP (P)

46.03' W.N.W. to sawed "+" north end RCP (P)

72.60' W.N.W. to duplex S/side cable marker post

59.82' N.W. to duplex SW/side telephone pole

46.34' N.E. to sawed "+" east end 15" CMP (P)

SW	

# Ridgeville Township

**Section** 36

**Date** 10/18/2005

**Corner** S¼

RR Spike

44.80' S.E. to 5/8" iron pin on south ditch bank

33.38' S. to 5/8" iron pin on south ditch bank (P)

42.29' S.W. to 5/8" iron pin on south ditch bank

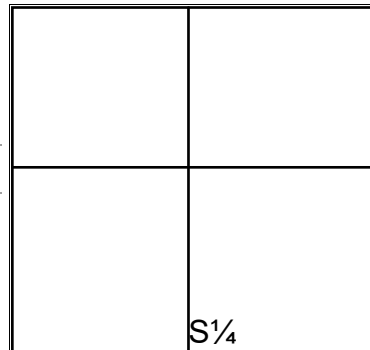

---

---

---

---

---

---

---

---